



**HITCHCOCK
DESIGN GROUP**

Focus on Multifamily



We are a national, multi-disciplinary landscape architecture, placemaking and urban design practice focused on building lasting relationships with the clients we serve, the communities we design for, and the colleagues we establish on every project.





East Village, Austin, Texas

Purposeful design is a multifamily differentiator.

Hitchcock Design Group's highly collaborative approach helps multifamily developers add measurable value to their properties. Our purpose is to improve people's lives and the communities in which they live, work and play through creative outdoor spaces. With a portfolio made up of clients and stakeholders similar to you, we understand what it takes to move projects like yours from vision to reality.

We understand the desires and demands of our audiences, resulting not just in timeless landscapes, but enhanced living experiences for all residents.



The Vaughan, Austin, Texas

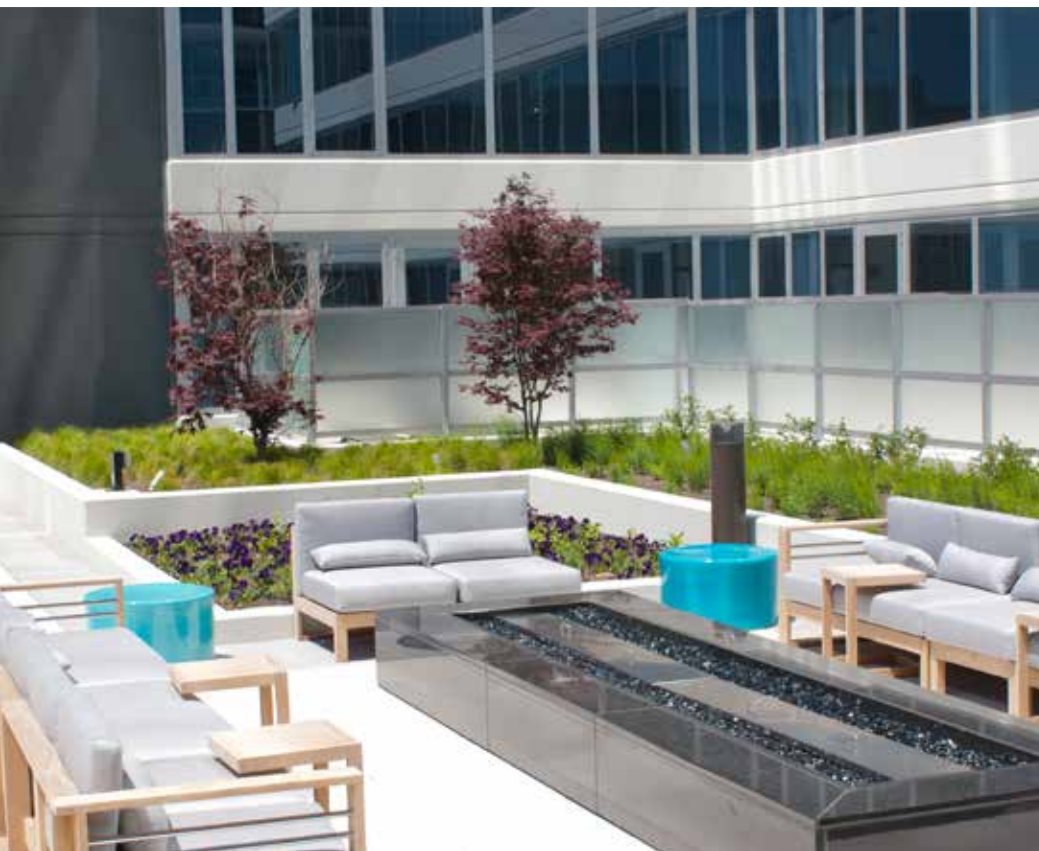

Amenity design that provides a sense of home.

We are passionately committed to making a difference in people's lives by providing high quality designs that value a supportive environment, flexible use spaces, and promote community.



Notch at Nora Apartments

Indianapolis, Indiana

Notch at Nora is a 186-unit multifamily apartment community in Indianapolis. With direct access to the Monon Trail, and adjacent to the Jordan YMCA and North Central High School, Notch at Nora provides the perfect location for pedestrian and bike friendly living. HDG designed of the outdoor amenity area, which provides a pool, outdoor grilling areas, and a dog park.





North + Vine Apartments, Chicago, Illinois



465 North Park

Chicago, Illinois

Hitchcock Design Group was retained as a part of the Pappageorge Haymes Partners team to assist with the design of the streetscape improvements, drop off, and rooftop amenity decks for this project located in the heart of Streeterville. Inspired by the leaves of an aspen tree, the overlapping leaf-shape nodes of the tower provided an opportunity for the design team to develop high-end amenity spaces that complement the architecture.

All images courtesy of © Pappageorge Haymes Partners



all images courtesy of © Pappageorge Haymes Partners



The Linden

Austin, Texas

The Linden is a 28-story, contemporary tower that introduces a new concept in inspired living where world-class luxury meets Austin's artful soul. Physically rooted near the iconic Capitol Corridor — as a residential destination — the property's metaphorical canopy extends to cover the adjacent arts and medical districts with unparalleled access to The University of Texas at Austin and other businesses.



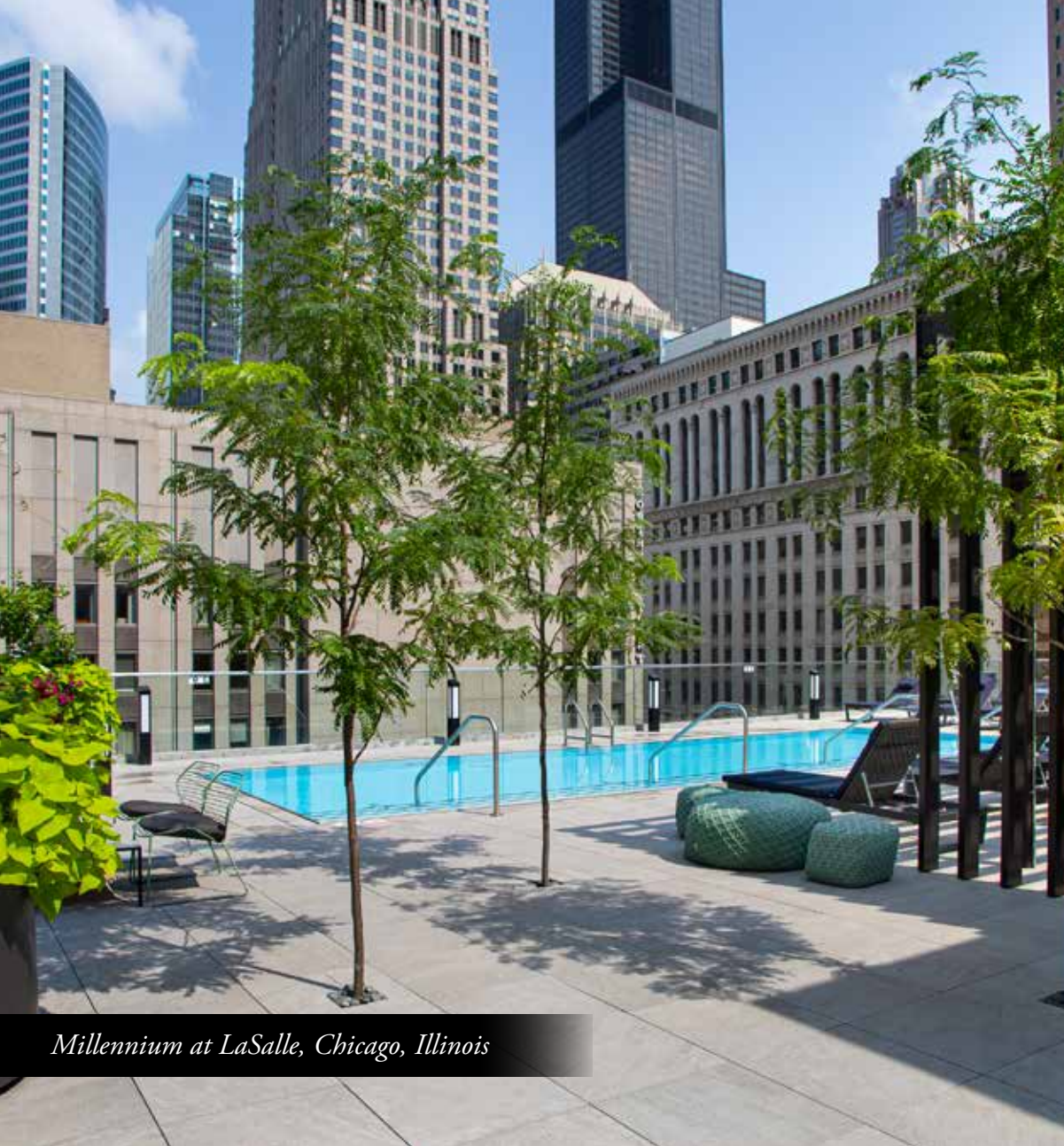

Millennium at LaSalle, Chicago, Illinois



One Oak

Austin, Texas

One Oak is a 106-unit condominium development along South First Street, in the Bouldin Creek neighborhood, just minutes from downtown Austin. HDG worked with Papageorge Haymes Civiltude and other stakeholders to design a variety of amenities including a fitness center and yoga lawn, a resort-style infinity edge pool, a fireside lounge, a courtyard bar, barbecue grills, poolside cabanas, and access to a trail along Bouldin Creek.





Chatham Apartments

Westfield, Indiana

Chatham Village marks the first multifamily offering in Westfield's popular Chatham master development. It joins posh Chatham Hills with its Pete Dye-designed golf course and other fast-growing Chatham Village communities. The project will consist of 250 luxury apartment units spread across two buildings. HDG designed the site landscape as well as amenities including a pool, grilling area, dog park, and lounge area.





Five One, Austin, Texas



Reside on Green Street

Chicago, Illinois

Hitchcock Design Group made improvements to the existing amenity decks including new furniture, an overhead pergola, built in grills and counters, an outdoor bar and kitchen, planters, lighting, TVs, updated finishes, and other site and landscape improvements. Streetscape improvements included railings within the planters, updated landscape, and additional planters and plantings.





Windsor at Miramar

Miramar, Florida

Windsor at Miramar was an existing Class B apartment complex when Windsor Communities purchased the property. In order to bring the project up to Windsor's standards, extensive upgrades were made throughout the property and the individual units. HDG designed a revamped courtyard between the leasing office and clubhouse which included new planting, signage, paving, and a refurbished fountain.





Lakeline Station, Austin, Texas

Presidium Chase Hill

San Antonio, Texas

Presidium Chase Hill is a stunning collection of one, two, and three-bedroom apartment residences in northwest San Antonio. With picturesque views of the scenic LaCantera golf course as a backdrop, residents enjoy an enviable location, captivating interiors, and amenity spaces. The 2-story clubhouse opens up to a resort style pool with an infinity edge, multiple sunshelves with cabanas in the cool water, outdoor living room and kitchen area.





Meet your multifamily market experts.

Welcome to the HDGNation! We are a dedicated and experienced team who understand your market, your mission and your language.



**TRENT RUSH, PLA, ASLA, LEED AP |
SENIOR PRINCIPAL**

Trent employs a collaborative design approach to provide clients with exceptional service and uniquely responsive design. Throughout over 20 years of professional experience, he has compiled a diverse portfolio of work which showcases his true passion, giving form to his clients' vision for their projects. For each project that he is involved with, Trent is devoted to enhancing each person's use and experience, which helps advise his approach to creating meaningful and memorable spaces. His team achieves a successful integration of their experience by emphasizing the pertinent role the environment plays in the use and enjoyment of the space.

(737) 402-5444
trush@hitchcockdesigngroup.com

Project Experience

4th at Navigation, Austin, Texas

7700 Parmer Lane, Austin, Texas

Berkshire, Fort Worth, Texas

Chase Hill Multifamily, San Antonio, Texas

City Gate West, Naperville, Illinois

Cotton Mill, McKinney, Texas

East Village - The Vaughan, Austin, Texas

Fulcrum, Austin, Texas

Mira, San Antonio, Texas

Oakcreek Multifamily, Leander, Texas

One Oak, Austin, Texas

Presidium at Tech Ridge, Austin, Texas

Presidium at Waterford, Austin, Texas

The Linden, Austin, Texas

The Paragon Place, Houston, Texas

Velocity Crossing, Austin, Texas



M.J. MENELEY , PLA, ASLA | PRINCIPAL

M.J.'s experience includes a focus on real estate development, higher education, and healthcare projects as well as a broad range of additional experience in community site planning, urban design, and estate design. Over a 25-year career, M.J. has developed design skills that provide value to each project, large or small, by being creative yet practical and maintainable. As Design Principal of HDG's Indianapolis Studio, M.J. helps to guide design direction on a variety of project types across several markets. M.J. is a resident of Indianapolis and an avid sketcher. He is skilled at setting the overall concept for project sites and helping clients realize the potential of each respective site.

(317) 613-6039

mjmeneley@hitchcockdesigngroup.com

Project Experience

Annex on the Square, Cedar Rapids, Iowa

The Assembly | Ford Building Historic Redevelopment, Indianapolis, Indiana

Bold on Boulevard, St. Peters, Missouri

Breakwater Apartments, New Albany, Indiana

Carden Flats PUD, Normal, Illinois

The Carlyle at Chatham Hills, Westfield, Indiana

Echelon at Greenwood Springs,
Greenwood, Indiana

Lockerbie Lofts, Indianapolis, Indiana

McDowell Point, Naperville, Illinois

Minnie Hartman Center, Indianapolis, Indiana

Notch at Nora, Indianapolis, Indiana

Playa Encantada Condominiums,
Holmes Beach, Florida

The Shelton Condominiums, Indianapolis, Indiana

The Wesmont, Indianapolis, Indiana

Windsor at Miramar, Miramar, Florida



JOEL BALDIN, ASLA | PRINCIPAL

An award-winning landscape architect since 1993, Joel has used his extensive planning, design, and project management skills to guide many projects from vision to implementation. Throughout his career, Joel has been highly involved in projects and organizations throughout the City of Chicago both professionally and personally and, as a result, has become a guiding force in the success of Hitchcock Design Group's Chicago portfolio. Joel's ability to identify a client's needs and manage critical project issues has resulted in the development of many long-standing client relationships. His experience includes complex urban design projects, historic landscape rehabilitation, parks and recreation, streetscape and plaza design, college and university campuses, commercial real estate, and multifamily housing.

(312) 660-7705

jbaldin@hitchcockdesigngroup.com

Project Experience

The Westerly, Chicago, Illinois

171 North Aberdeen "Quarters,"
Chicago, Illinois

465 North Park Drive, Chicago, Illinois

Arkadia Tower, Chicago, Illinois

Lake Point Tower, Chicago, Illinois

Mid Town Square, Glenview, Illinois

Green Exchange, Chicago, Illinois

Halsted Point, Chicago, Illinois

Old Town Park Mixed-Use Developement,
Chicago, Illinois

The Lofts at 1800, Chicago, Illinois

University Village Ivy Hall, Chicago, Illinois

HITCHCOCKDESIGNGROUP

AUSTIN | CHICAGOLAND | INDIANAPOLIS | SOUTH FLORIDA

hitchcockdesigngroup.com